

INSTALLATION INSTRUCTIONS FOR CORNERSEAL™ INSIDE CORNER MOLDING

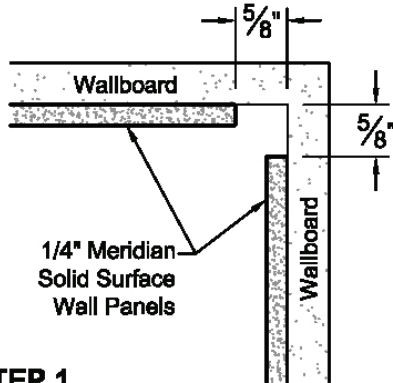

STEP 1

Install Meridian Solid Surface Wall Panels per published Tower Industries instructions, leaving 5/8" gap between the vertical edge of each panel and the inside corner of the wallboard.

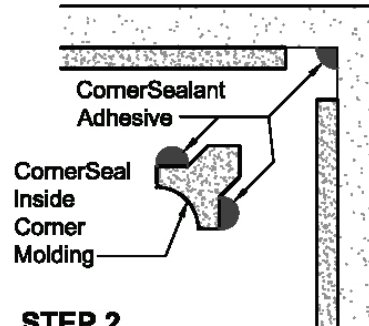

STEP 2

Apply a 1/4" bead of CornerSealant adhesive to the wallboard in the corner between the panel edges as shown above. Apply two additional beads of CornerSealant adhesive to the back side of the CornerSeal molding at each outside edge as shown above.

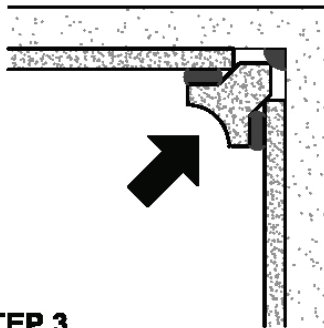

STEP 3

Insert the CornerSeal molding into the void between the panel edges until the adhesive squeezes out uniformly along the entire length of each vertical edge.

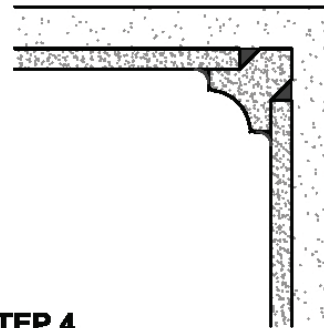

STEP 4

Wipe off the excess CornerSealant adhesive from both vertical edges. If the adhesive did not squeeze out uniformly along the entire edge, pull the molding out immediately, add additional CornerSealant adhesive, then re-install.

All installation instructions are provided as a recommendation only and are not intended for design purposes. Tower Industries makes no representations or warranties of any kind concerning these instructions. Tower Industries strongly recommends that the installer test the installation materials and methods in the anticipated service conditions to determine suitability. Due to variances in installation skill and jobsite conditions, Tower Industries cannot accept liability for the results obtained.

06.15.2012 Rev C