



## INSTALLATION INSTRUCTIONS FOR SHOWER WALL PANELS

1. Verify that the shower base or bathtub is properly installed and level. Also verify that moisture-resistant wallboard or cement board has been installed down to the highest point of the water dams.
2. If recessed soap and shampoo holders are going to be installed, locate and mark the area for the cutout in the wallboard, ensuring that there are no wall studs, wires, or pipes in the way. Cut the hole in the drywall approximately 1/2" smaller than the accessory.
3. Beginning with the back wall panel, place the wall panel in its intended location WITHOUT any adhesive applied. Mark locations and amounts to be trimmed or scribed, as well as the locations of plumbing and accessory cutouts. Cut openings in the panel as necessary for plumbing and accessories. Trim/scribe edges of panel so that the resulting gap at the perimeter is not more than 1/8" when installed.
  - a. Use a carbide hole saw to cut smaller holes.
  - b. Use an electric router with a single-flute bit and a jig to cut larger holes or irregular shapes. As an alternate, you may also use a jig saw with an abrasive blade (*look for the package labeled "for ceramics" or "glass and tile"*), but be aware that this method may result in chipping of the edge, which must be sanded smooth prior to proceeding.
  - c. Use a circular saw with a masonry blade or a belt sander with 80-grit sandpaper to trim and scribe the edges of the wall panel.

*Please Note:* Make all cuts from FINISHED SIDE and be sure to PROTECT THE SURFACE with masking tape.

*DO NOT leave square inside corners when adding cutouts to wall panels. ALL inside corners must have a minimum 1/4" radius to avoid the potential for cracks later.*

*Lightly sand the inside of all cut openings to remove any small chips that may have occurred during the cutting process. The inside of the cutout should be smooth to the touch with no sharp edges.*

*Unless otherwise specified at the time of order, shower wall panels are typically supplied slightly oversized for trimming and scribing at time of installation.*

4. Once all trimming, scribing, and cutouts have been completed, clean the back of the panel thoroughly with isopropyl alcohol or acetone (*Please check local laws regarding the use of acetone and/or other solvents in your area*). Then, apply a heavy, continuous bead of SoudaSeal® All-Purpose Adhesive around the perimeter of the panel about 1-1/2" in from each edge. Continue to apply adhesive per the manufacturer's instructions in quarter-size drops no more than 12" apart throughout the remainder of the panel.

*Please Note:* Hot melt adhesive or wood braces may be used to hold panels in place while the adhesive cures. Apply hot melt on each corner approximately 1" from each edge or cut wood braces to wedge against the panels while the adhesive cures, being sure to protect the face of the panels with padding or towels.

5. Repeat steps 3 and 4 for each wall panel.
6. Install shower trim moldings and accessories, if applicable, using SoudaSeal® All-Purpose Adhesive.
7. Caulk all joints using 100% Silicone caulk or Acrylic Latex caulk.

**SEE DIAGRAMS ON PAGE 2**

02.14.2016 Rev F

Page 1 of 2

P: 330.837.2216  
F: 330.837.2642

2101 Ninth Street S.W.  
Massillon, OH 44647

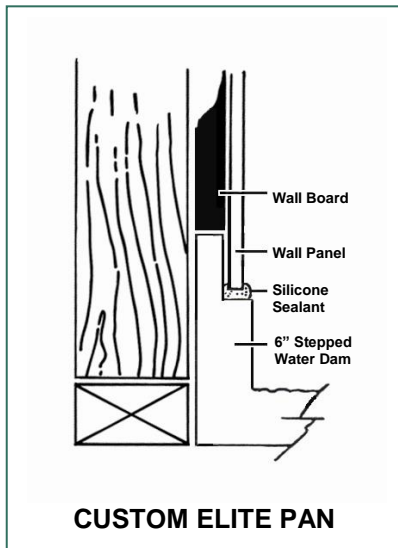
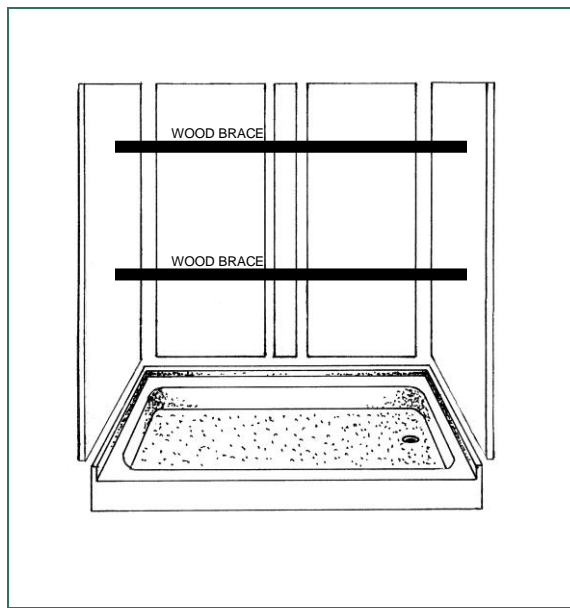

**CUSTOM ELITE PAN**

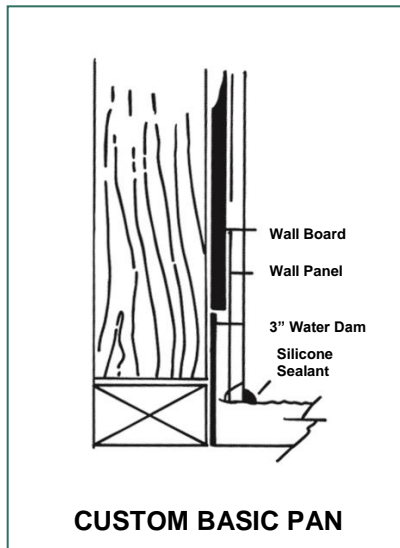

**CUSTOM BASIC PAN**

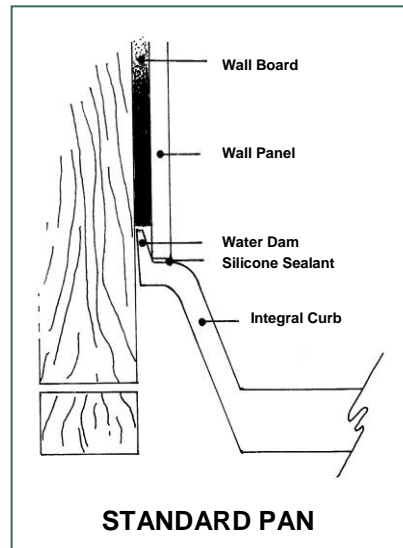

**STANDARD PAN**

*All installation instructions are provided as a recommendation only and are not intended for design purposes. Tower Industries makes no representations or warranties of any kind concerning these instructions. Tower Industries strongly recommends that the installer test the installation materials and methods in the anticipated service conditions to determine suitability. Due to variances in adhesives, installation skill, and jobsite conditions, Tower Industries cannot accept liability for the results obtained.*